

Mounting Instructions INNOMOUNT

Systems:

Blaser / CZ550 / Merkel B3-B4 /
Sauer 303 / Tikka T3 /
Weaver - Picatinny / 12 mm - Prisma

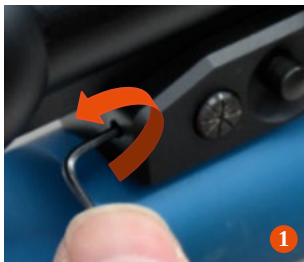

1. Mounting on the mounting base

For setting the mount, it must be mounted on the mounting base provided to this end. To do so, loosen or unscrew the two clamping screws **1** fastened to the front of the mounting body and the two adjusting screws (star screws) **2** secured by them. Once the adjusting screws (star screws) have been unscrewed and the clamping levers opened to 90°, the mount can at any time be easily mounted onto the mounting base **3**. The mount can be set both with unmounted telescopic sight or with the telescopic sight already mounted on the mounting body.

2. Aligning and closing the clamping levers

For accurately setting the mount, the clamping levers must be aligned horizontally and closed **4**.



3. Setting the clamping force

Tightening the two adjusting screws (star screws) **5** allows you to set the clamping force. The higher you select the torque, the higher the clamping force and thus the directly related closing and opening force of the clamping lever will be. Choose a torque for the adjustment screws that is high enough to just allow the release buttons to be pressed.



4. Locking the setting

For checking the function/setting, all loosened clamping screws **6** must first be retightened. If the clamping force is to be changed, the two clamping screws must again be loosened, the adjusting screws turned and the clamping screws retightened. There it must be ensured that an even available adjustment range is guaranteed, in which one clamping lever with clamping jaws for clamping screws loosened can be pressed into the mounting base **7**.

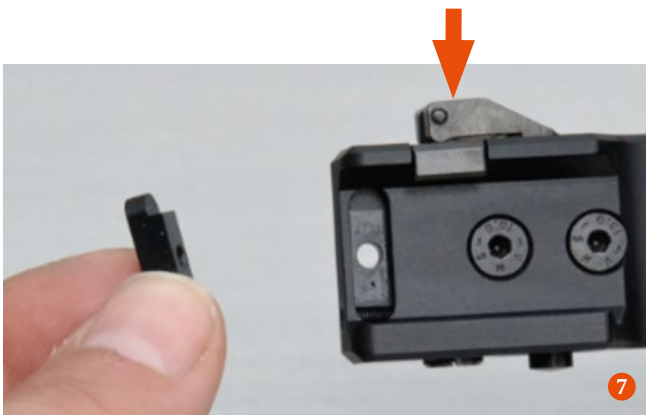

5. Mounting the axial stop

The axial stop **7 must, seen in the direction of fire only, be inserted into the dedicated recess in the front. The torque of the fastening screw should be approx. 2Nm. Secure the screw with glue.**

For the Weaver / Picatinny base, axial Stops are available in widths of 4mm and 5mm.

